

TIPO TYPE	Potenza nominale Puiss. Nominale Nominal power HP   kW		AMPERE		Q = portata – débit – capacity													
			Monofase Monophasé Single-phase	Trifase Triphasé Three-phase	m³/h 0	1.5	3	4.5	6	7.5	9	10.5	12	15	18	24	30	36
			1 x 220 V 50Hz	3 x 380 V 50Hz	l/1' 0	25	50	75	100	125	150	175	200	250	300	400	500	600
Prevalenza manometrica in m. C.A. – Hauteur manométrique en m. – Total head in meters w.c.																		
G2Z/45	1	0.74	5.5	2.5	44	41.5	37	22.5										
G2Z/55	1.5	1.1	8.8	3.4	54.5	53	49	39	31									
G2Z/65	2.2	1.65	7.8	4.2	59	58.5	54	47	39	28								
G2Z/70	3	2.2	9.2	5.4	66	65	61	54	46.5	36.5								
G2Z/75	4	3	21.5	7.6	66.9	63.9	63.3	61	58.4	55.2	51.5	47.8	44.2					
G2Z/85	5.5	4	-	9.5	78.7	77.1	76.1	74.6	72	69.4	66	62.4	58.7					
G2Z/95	7.5	5.5	-	14.7	90	89	88.6	87	84.8	82.3	79.2	76.3	72.5	62.7				
G2ZH/80	7.5	5.5	-	15	77	76.5	75.7	74.9	74	73.5	73	71.2	70.5	66.4	62.8	51.6	36	
G2ZH/90	10	7.5	-	17.2	86.4	86.1	85.8	85.3	84.8	84	83.2	81.5	80.7	77.7	74.3	65	51.1	
G2ZH/100	12.5	9.2	-	18.9	93.6	93.1	92.5	91.8	91	90	88.9	87.6	86.3	83	79.7	70.5	55.2	
G2ZH/110	15	11	-	20.4	98.7	98.6	98.5	98	97.6	97	96.4	95.3	94.2	91.5	87.6	78.2	62.3	40.9

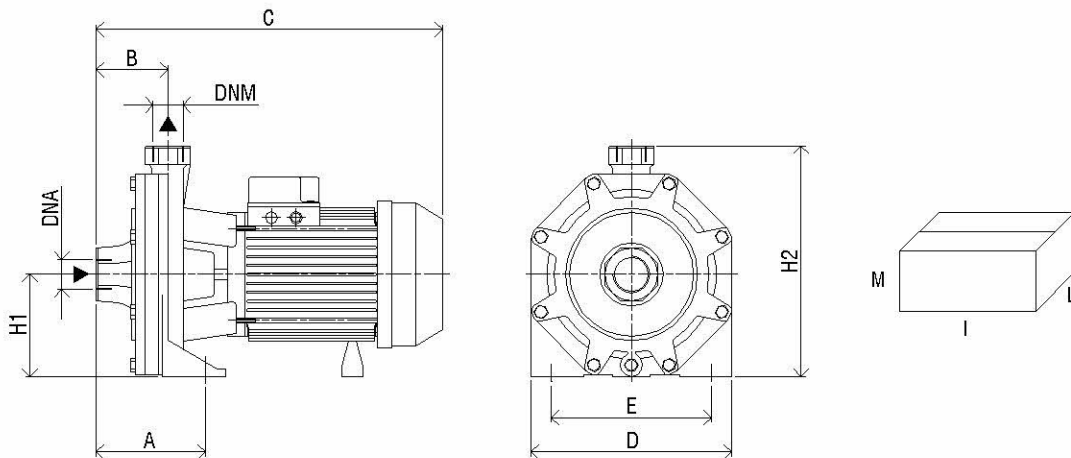

TIPO TYPE	Dimensioni mm Dimensions mm Dimensions mm									Dimensioni imballo mm Dimensions d'emballage mm Packing dimensions mm			Peso Poids Weight Kg
	A	B	C	D	E	H1	H2	DNA	DNM	I	L	M	
G2Z/45	122	73	328	180	140	98	228	1"G	1"G	350	195	265	15.3
G2Z/55	141	83	385	210	170	115	264	1"¼G	1"G	405	225	295	24
G2Z/65	141	83	385	210	170	115	264	1"¼G	1"G	405	225	295	23.4
G2Z/70	141	83	385	210	170	115	264	1"¼G	1"G	405	225	295	23.4
G2Z/75	145	95.5	463	266	212	135	305	1"½G	1"¼G	500	275	350	41
G2Z/85	145	95.5	463	266	212	135	305	1"½G	1"¼G	500	275	350	44.8
G2Z/95	145	95.5	463	266	212	135	305	1"½G	1"¼G	500	275	350	50.5
G2ZH/80	190	120	605	275	210	150	330	2"G	1"¼G	640	310	370	70.5
G2ZH/90	190	120	605	275	210	150	330	2"G	1"¼G	640	310	370	77
G2ZH/100	190	120	645	275	210	150	330	2"G	1"¼G	640	310	370	85
G2ZH/110	190	120	645	275	210	150	330	2"G	1"¼G	640	310	370	92



Via Sale 119/121 - 25064  
Gussago (Brescia) ITALIA  
Vendite Italia Telefono 0302775.419  
e-mail: comm@gmppumps.com  
Export Telephone 0302775.414  
e-mail: export@gmppumps.com  
Fax 0302771137 - 0302772418

ELETTROPOMPE CENTRIFUGHE 2 giranti  
*ELECTROPOMPES CENTRIFUGES 2 turbines*  
*CENTRIFUGAL ELECTRIC PUMPS twin impellers*

# G2Z – G2ZH

Serie - Série - Serie



G2Z

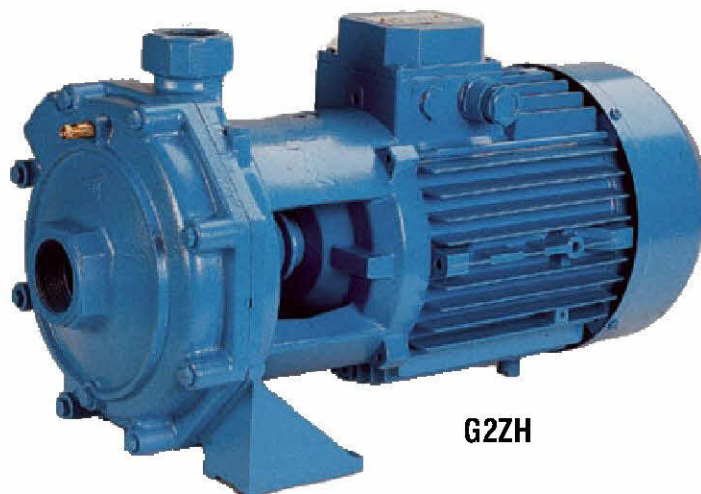

G2ZH

## CARATTERISTICHE

Corpo pompa e supporto in ghisa (G20/G25), albero in acciaio inox, girante in noryl su modello G2Z/45, in lega di ottone stampata sui modelli G2Z/55, G2Z/65, G2Z/70, G2Z/75, G2Z/85, G2Z/95, G2ZH/80, G2ZH/90, G2ZH/100, G2ZH/110. Tenuta meccanica in grafite e ceramica.

Il motore è di tipo ad induzione con rotore a gabbia, a 2 poli, chiuso e autoventilato, adatto per servizio continuo S1, con grado di protezione IP 54 e isolamento in classe B per potenze inferiori o uguali a 0,88 kW (1,2 HP) e in classe F per le potenze superiori.

## CARACTERISTIQUES

Corps de pompe et support en fonte (G20/G25), arbre en acier inox, turbines en noryl sur modèle G2Z/45, en alliage en laiton estampé sur le modèle G2Z/55, G2Z/65, G2Z/70, G2Z/75, G2Z/85, G2Z/95, G2ZH/80, G2ZH/90, G2ZH/100, G2ZH/110. Garniture mécanique en céramique et graphite.

Le moteur électrique est du type d'induction avec rotor à cage, à 2 pôles, fermé et autoventilé, indiqué pour service continu, avec degré de protection IP 54 et isolation en classe B pour puissances inférieures ou égales à 0,88 kW (1,2 HP) et en classe F pour puissances supérieures.

## SPECIFICATIONS

Pump body and motor bracket in cast iron (G20/G25), shaft in stainless steel, impeller in noryl for Mod. G2Z/45, impeller in stamped brass for Mod. G2Z/55, G2Z/65, G2Z/70, G2Z/75, G2Z/85, G2Z/95, G2ZH/80, G2ZH/90, G2ZH/100, G2ZH/110. Ceramic and graphite mechanical seal.

Enclosed and self-ventilated induction electric motor with short-circuit rotor, two poles, suitable for continuous duty, IP 54 protection degree and class B insulation for nominal power inferior or equal to 0,8 kW (1,2 HP) and class F insulation for nominal power superior to 0,88 kW.